

1877626-1 ✓ ACTIVE

AMP | AMP GPR

TE Internal #: 1877626-1

Rectangular Connector Seals, Seal Assembly, Wire-to-Wire,
Sealable, Wire & Cable, Signal, AMP GPR

[View on TE.com >](#)



Connectors > Rectangular Connectors > Rectangular Connector Accessories > Rectangular Connector Seals

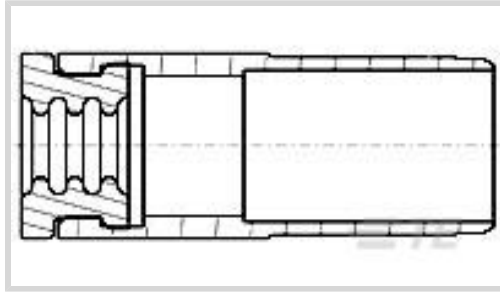

Connector Seal Type: **Seal Assembly**

Connector System: **Wire-to-Wire**

Sealable: **Yes**

Connector & Contact Terminates To: **Wire & Cable**

Circuit Application: **Signal**

Features

Product Type Features

Product Type	Accessory
Connector Style	Plug
Connector Seal Type	Seal Assembly
Connector System	Wire-to-Wire
Sealable	Yes
Connector & Contact Terminates To	Wire & Cable

Operation/Application

Circuit Application	Signal
---------------------	--------

Packaging Features

Packaging Quantity	1000
--------------------	------

Other

Comment	Recommended cables are Tensolite NF24Q100, ABS1503KD24 or equivalent.
---------	---

Product Compliance

[For compliance documentation, visit the product page on TE.com>](#)

EU RoHS Directive 2011/65/EU	Compliant
EU ELV Directive 2000/53/EC	Compliant
China RoHS 2 Directive MIIT Order No 32, 2016	No Restricted Materials Above Threshold



EU REACH Regulation (EC) No. 1907/2006

Current ECHA Candidate List: JUNE 2022 (224)

Candidate List Declared Against: JAN 2019 (197)

Does not contain REACH SVHC

Halogen Content

Not Yet Reviewed for halogen content

Solder Process Capability

Not applicable for solder process capability

Product Compliance Disclaimer

This information is provided based on reasonable inquiry of our suppliers and represents our current actual knowledge based on the information they provided. This information is subject to change. The part numbers that TE has identified as EU RoHS compliant have a maximum concentration of 0.1% by weight in homogenous materials for lead, hexavalent chromium, mercury, PBB, PBDE, DBP, BBP, DEHP, DIBP, and 0.01% for cadmium, or qualify for an exemption to these limits as defined in the Annexes of Directive 2011/65/EU (RoHS2). Finished electrical and electronic equipment products will be CE marked as required by Directive 2011/65/EU. Components may not be CE marked. Additionally, the part numbers that TE has identified as EU ELV compliant have a maximum concentration of 0.1% by weight in homogenous materials for lead, hexavalent chromium, and mercury, and 0.01% for cadmium, or qualify for an exemption to these limits as defined in the Annexes of Directive 2000/53/EC (ELV). Regarding the REACH Regulation, the information TE provides on SVHC in articles for this part number is based on the latest European Chemicals Agency (ECHA) 'Guidance on requirements for substances in articles' posted at this URL: <https://echa.europa.eu/guidance-documents/guidance-on-reach>

Also in the Series | AMP GPR



Connector Contacts(2)

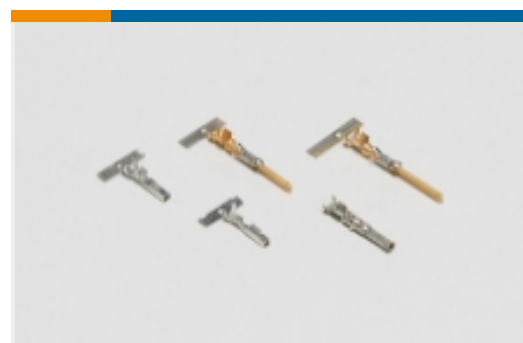

Power Contacts(9)

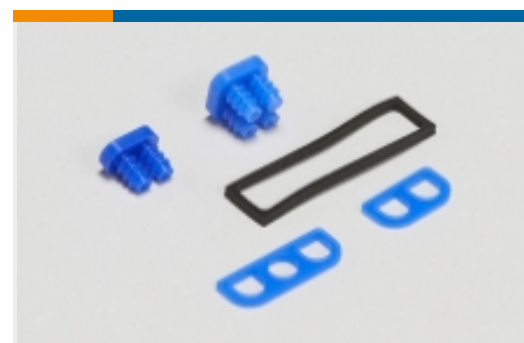

Rectangular Connector Seals(2)



Standard Rectangular Connectors(1)

Documents

Product Drawings

Seal Assembly,Size 8 GPR

English

CAD Files

3D PDF

3D

Customer View Model

ENG_CVM_CVM_1877626-1_C.2d_dxf.zip

English

Customer View Model

ENG_CVM_CVM_1877626-1_C.3d_igs.zip

English



Customer View Model

[ENG_CVM_CVM_1877626-1_C.3d_stp.zip](#)

English

By downloading the CAD file I accept and agree to the [Terms and Conditions](#) of use.

Datasheets & Catalog Pages

[ARINC 600 Next Generation Receptacle Connector](#)

English